



SPEED LIMIT
30KM/HR



SAFETY WEAR/PERSONAL PROTECTIVE
EQUIPMENT (PPE)
must be worn on the Terminal at all times
(as per risk assessment)

NO USE OF
HAND HELD
CELL PHONE /
ELECTRONIC
DEVICES
WHILE
DRIVING

BEACON
LIGHT ON



NO UNAUTHORISED
WALKING ON THE TERMINAL

EMERGENCY TEL : 2225 1606
TRANSPORT TEL : 2225 2365

Legend:

Traffic Direction

STOP

Designated Parking Area

Boundary Area Fence Line

Security /Customs Controlled Access Gates

Controlled Access To W/h medserv and OTM

Under Quay cranes: Only freeport
trucks and OPS support equipment

Lifter Stacks

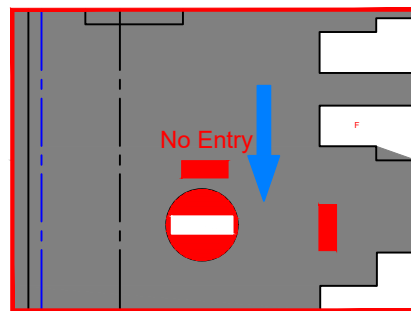

Emergency
Evacuation
Access

MFT
Terminal
Out-mustering
Building

MFT Employee Car Park

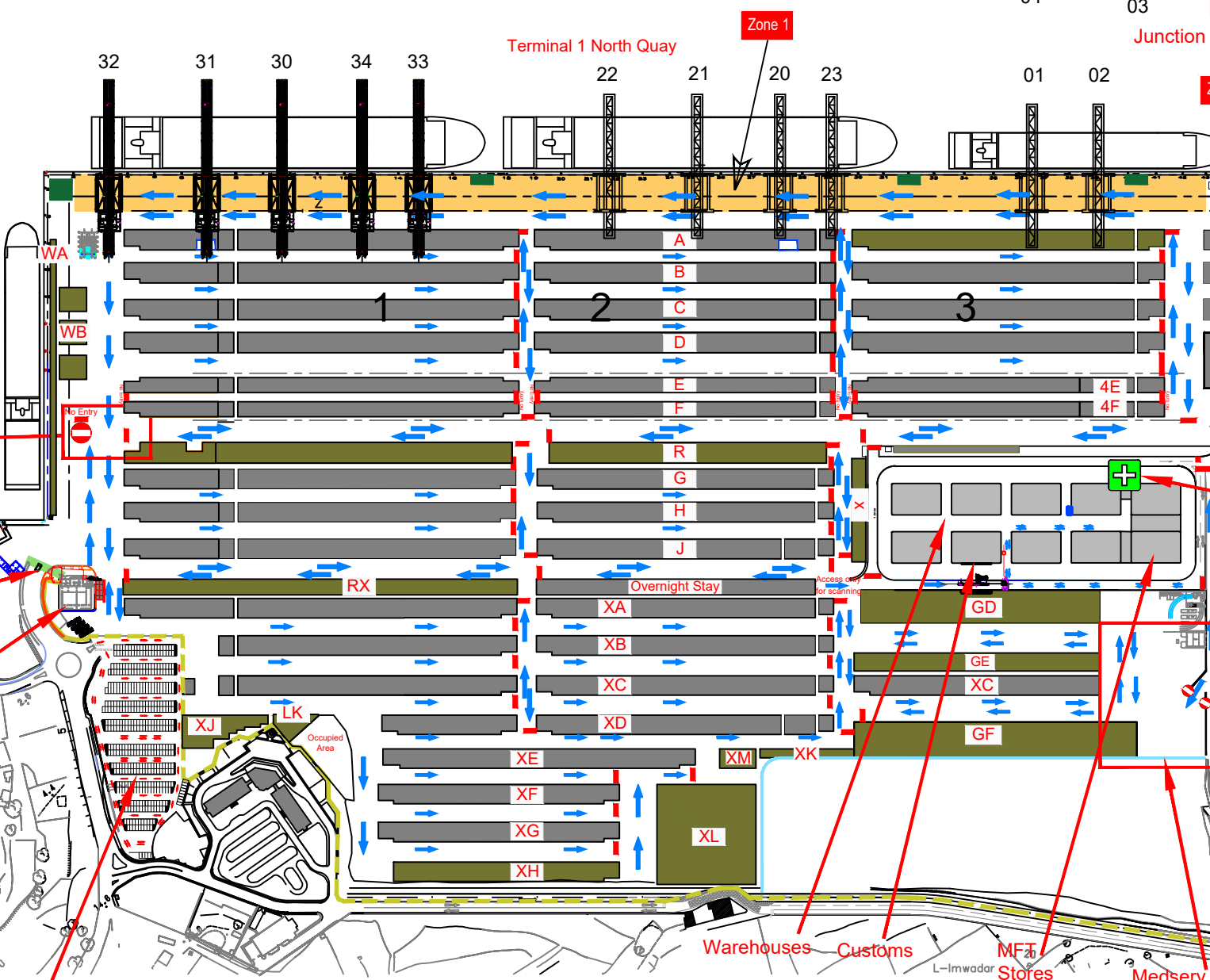
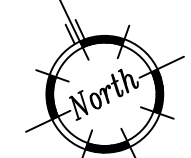
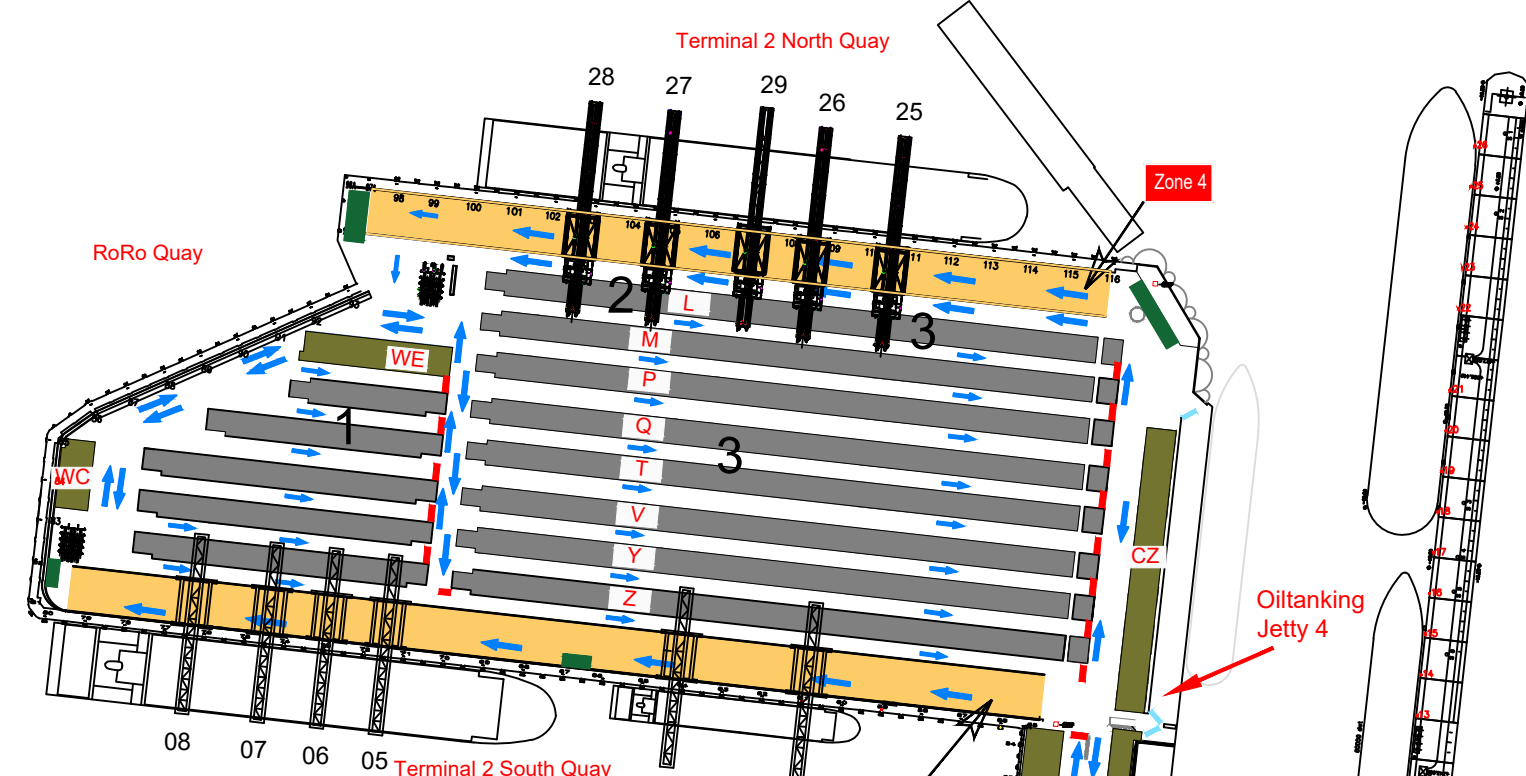

Oiltanking
Jetty 4

Medserv
Quay

MFF

First Aid Clinic

No Entry except for engineering
and light operations' vehicles

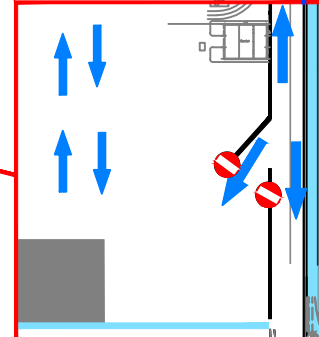

Wied Ix-Xoqqa

Main Gate

Border Inspection Post

Warehouses

Customs

MFT
Stores

Medserv Gate

Only Third party vehicles authorised to provide a service to vessels are allowed on the quayside.

